

# 1 Elevator overload control system EOS-C(1) (instalation under the cab floor)

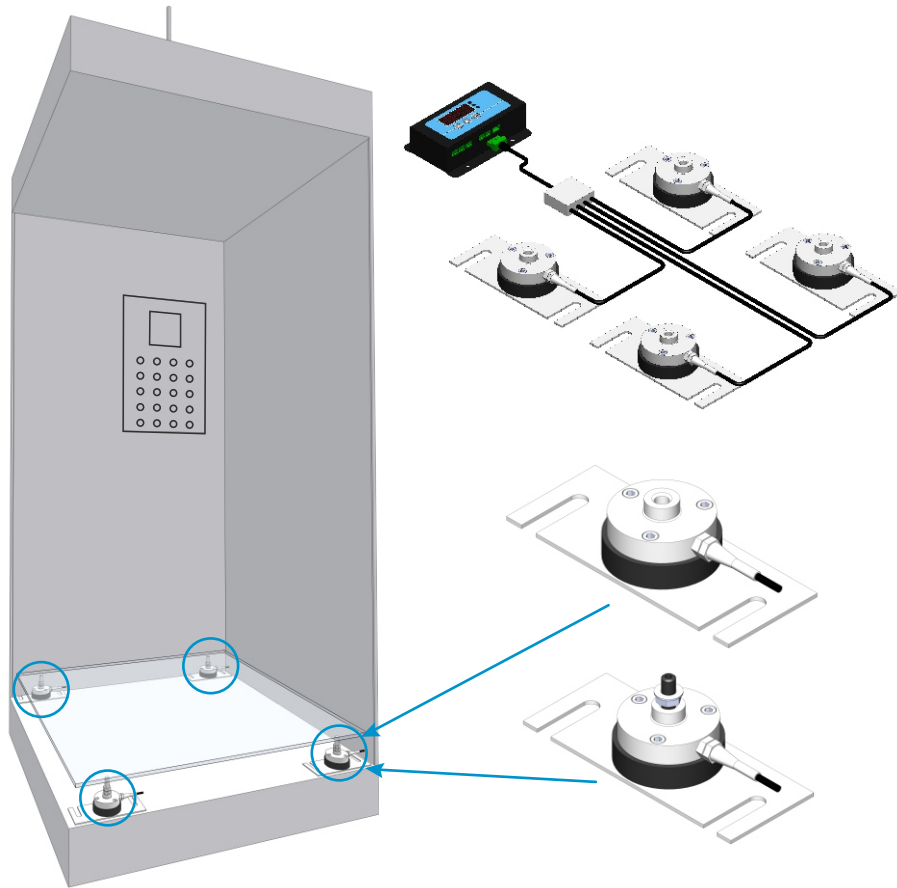

## Set Contains

Quantity	Full article description
4 / 6 / 8 / 12	Load Cell
1	IP65 Junction Box
1	Indicator

## Technical characteristics

The set of load cells designed to install under the elevator cabin. The rated loading capacity of the load cell is 1 ton. The load cells have a protective sleeve against cable bending and a fixing gland to provide the IP 67 degree of protection. The load cells are mounted on shock absorbers to protect against dynamic influences during the movement of the elevator and provide an equal load of the load cells. The round shape of the load cell makes it possible to compensate for parasitic non-axial forces.

Studs and nuts are included in the kit EOS-C(1). Kit EOS-C is fully the same, but without studs and nuts.

Capacity	4000kg, 6000kg, 8000kg, 12000kg
Maximum short-time overload	12000kg, 18000kg, 24000kg, 36000kg
Load cell capacity	1000kg
Accuracy class	0,5%
Quantity of relay outputs	3
Levels of relay outputs	15 kg (passenger availability) 90% (move without stopping) 110% (overload)
Supply voltage	-230±20V 50±1Hz -24±4V (option)
Working temperature range	-10...+50°C
Protection class	- Indicator - Load cells
	IP54 IP67
Warranty	3 years

## Overall dimensions (mm)

